

Spell Community
Township 9 North
Range 15 West
Covington County, Ms.

N
S

* SS-USA to William Speed 5-2-1859
and deeded to WF+KC Spell
1-29-1857
** KC- Keziah Catherine Speed Spell
*** SS- not known when William Speed
got this - deeded to WF + KC Spell
1-29-1857

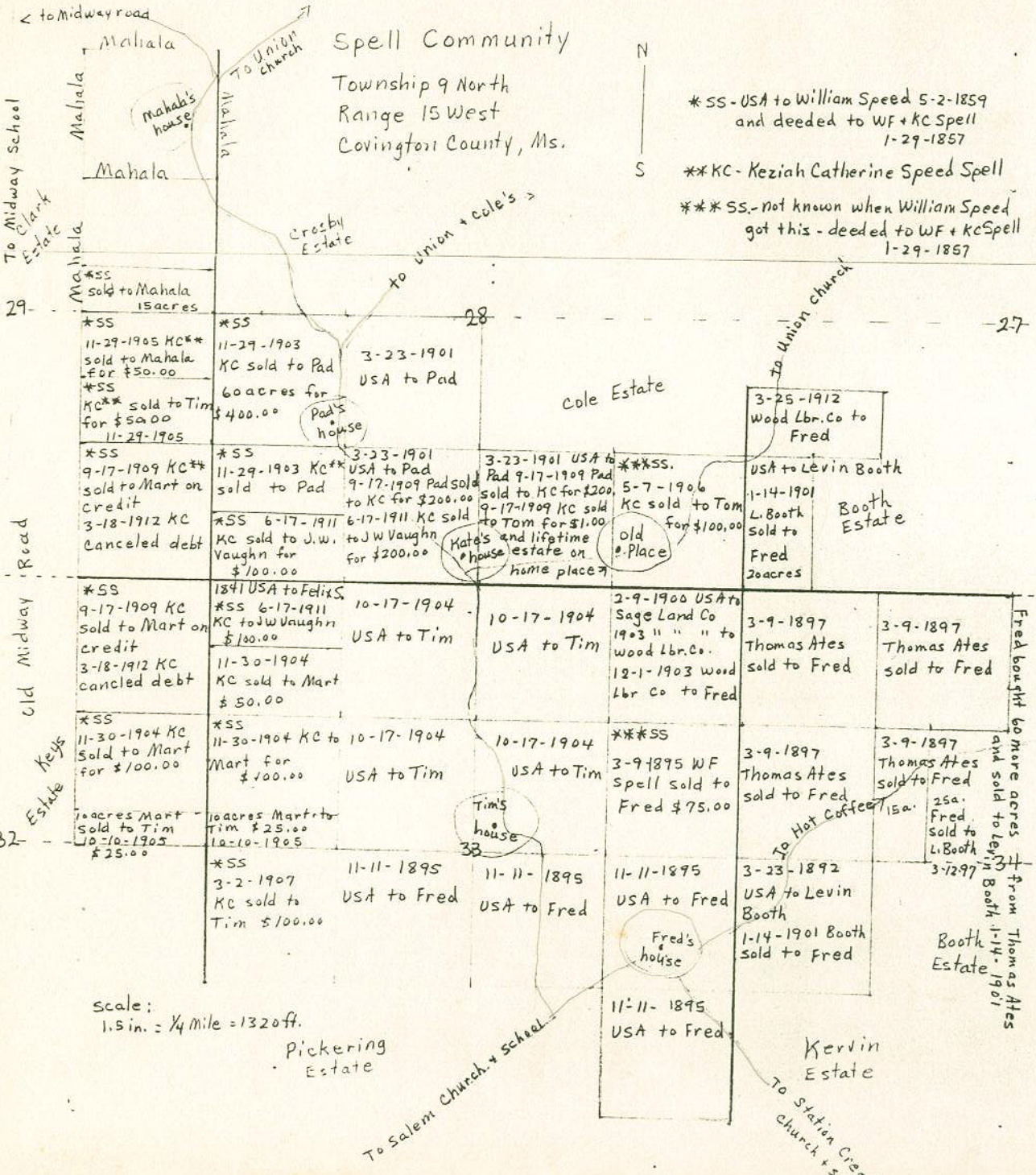

Scale:
1.5 in. = 1/4 mile = 1320 ft.

Pickering Estate

Kervin Estate

To Salem Church + school

To Station Creek Church + school

Fred bought 60 more acres
and sold to Levin Booth
1-14-1901 from Thomas Ates

Booth Estate

3-9-1897 Thomas Ates sold to Fred 25a.
Fred sold to L. Booth
3-7-297

To Hot Coffee

Fred's house

Tim's house

Maha's and lifetime estate on home place

Cole Estate

Booth Estate

3-25-1912 Wood Lbr. Co to Fred
USA to Levin Booth
1-14-1901 L. Booth sold to Fred
Jo acres

***SS.
5-7-1906 KC sold to Tom for \$100.00
old place

3-23-1901 USA to Pad
9-17-1909 Pad sold to KC for \$200.00
9-17-1909 KC sold to Tom for \$100.00

11-29-1903 KC sold to Pad
60 acres for \$400.00
Pad's house

11-29-1905 KC** sold to Maha for \$50.00
11-29-1905 KC** sold to Tim for \$50.00

9-17-1909 KC** sold to Mart on credit
3-18-1912 KC canceled debt

9-17-1909 KC sold to Mart on credit
3-18-1912 KC canceled debt

11-30-1904 KC sold to Mart for \$50.00
11-30-1904 KC sold to Mart for \$100.00

10 acres Mart sold to Tim 10-10-1905 \$25.00

1841 USA to Felix S.
10-17-1904 USA to Tim

11-30-1904 KC sold to Mart for \$50.00

10-17-1904 USA to Tim

11-11-1895 USA to Fred

11-11-1895 USA to Fred

11-11-1895 USA to Fred

11-11-1895 USA to Fred

11-11-1895 USA to Fred

11-11-1895 USA to Fred

11-11-1895 USA to Fred

to Midway road
Mahala
Mahala
Mahala
Mahala
Mahala
29
Road
Old Midway Road
Estate Keys
32

to Union Church
Mahala
Crosby Estate
to Union + Cole's
28
27

To Station Creek Church + school